



29/8 Warumbui Avenue Miranda, NSW

 3

 2

 2

Spacious Townhouse

- Full brick townhouse in a wonderfully central setting
- Large, flexible dining and living area
- Glass sliders link living to two courtyards for entertaining
- Granite and gas kitchen looks to courtyard, with stainless appliances and semi-integrated dishwasher
- Extra large master with balcony, ensuite and walk-in wardrobe
- Built-in wardrobes for two bedrooms
- Split-system air conditioning, under stair storage, ground floor toilet with laundry
- Basement parking in oversized garage with storage space
- Low maintenance gardens with shed
- Moments to Seymour Shaw Park and hospitals
- Easy walk or ride to Our Lady Star of The Sea Catholic School

Price: \$1075000

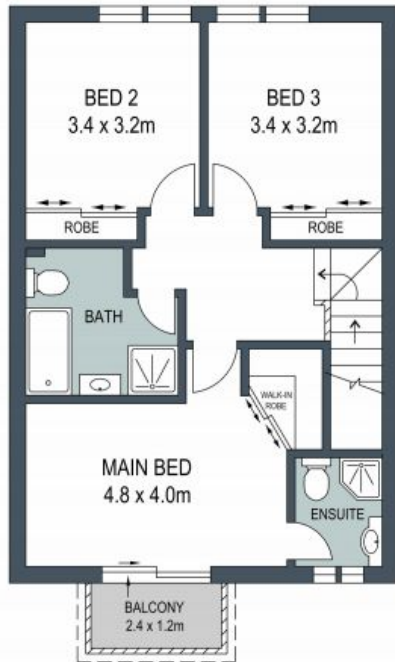

FIRST FLOOR

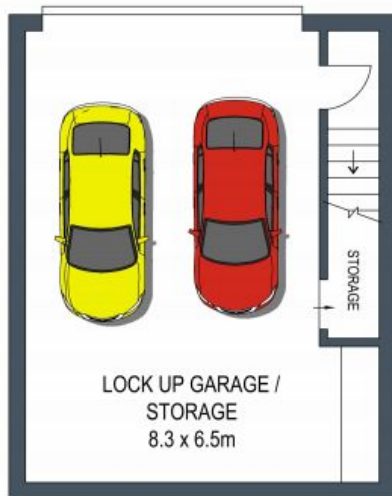

LOWER GROUND FLOOR



GROUND FLOOR

ADDRESS:

29/8 Warumbui Avenue, Miranda

DISCLAIMER: THIS IS FOR ILLUSTRATIVE PURPOSES ONLY, ALL DIMENSIONS ARE APPROXIMATE AND IT DOES NOT CONSTITUTE PART OF ANY LEGAL DOCUMENTS.

