



252 President Avenue Miranda, NSW



5



3



2

Elegant Charm

- Exquisite facade with stained glass windows, veranda and gabled roof
- Sizeable open-plan living and dining room with modern designer finishes
- Large family kitchen with stone benchtops and stainless appliances
- Generous bedrooms with built-ins, master features an ensuite
- Second bedroom with enclosed balcony, perfect for guests, home office or rumpus
- Family bathroom, with floor to ceiling tiles and separate bathtub
- Ornate high ceilings, blackbutt timber floors, a/c, internal laundry
- Video intercom system, solar panels, wide hallways and ornate door frames
- Large double garage with three-phase power, self-contained flat
- Rear retreat flows out onto an entertainers' deck and heated inground pool

Price: \$1512000

Council Rates: \$430.00 p/q

Water Rates: \$331.00 p/q

Harwood
PROPERTY AGENTS

Lucas Harwood

0431 001 001

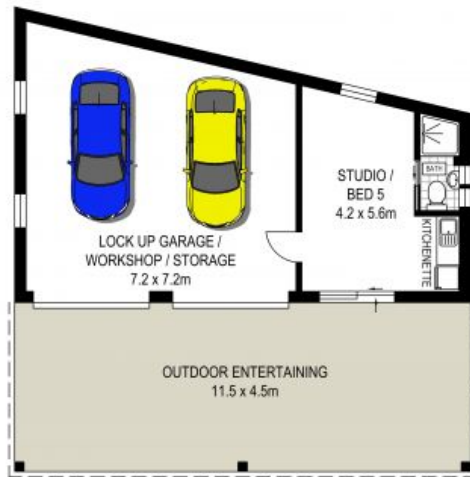

GROUND FLOOR



SITE PLAN (NOT TO SCALE)



ADDRESS:

252 President Avenue, Miranda

DISCLAIMER: THIS IS FOR ILLUSTRATIVE PURPOSES ONLY, ALL DIMENSIONS ARE APPROXIMATE AND IT DOES NOT CONSTITUTE PART OF ANY LEGAL DOCUMENTS.