

259 Sylvania Road Gymea Bay, NSW



5



2



1

## Renovated Delight

- Situated on an expansive 694sqm site with a 15.24m frontage (approx.)
- Multiple, light-filled living and dining areas
- New, modern kitchen with quality appliances, dishwasher included
- Master bedroom provides the convenience of an ensuite and external access
- Four additional, proportioned bedrooms with three featuring mirrored built-in wardrobes
- Well-sized bathroom and a combined second bathroom with laundry
- Air-conditioning, linen or storage cupboard and a peaceful sun room
- Freshly painted walls, polished timber floorboards and new vertical blinds
- Level grassed backyard and a lock-up garage with a generous storage area

**Price:** \$700

**Harwood**  
PROPERTY AGENTS

**Lucas Harwood**

0431 001 001

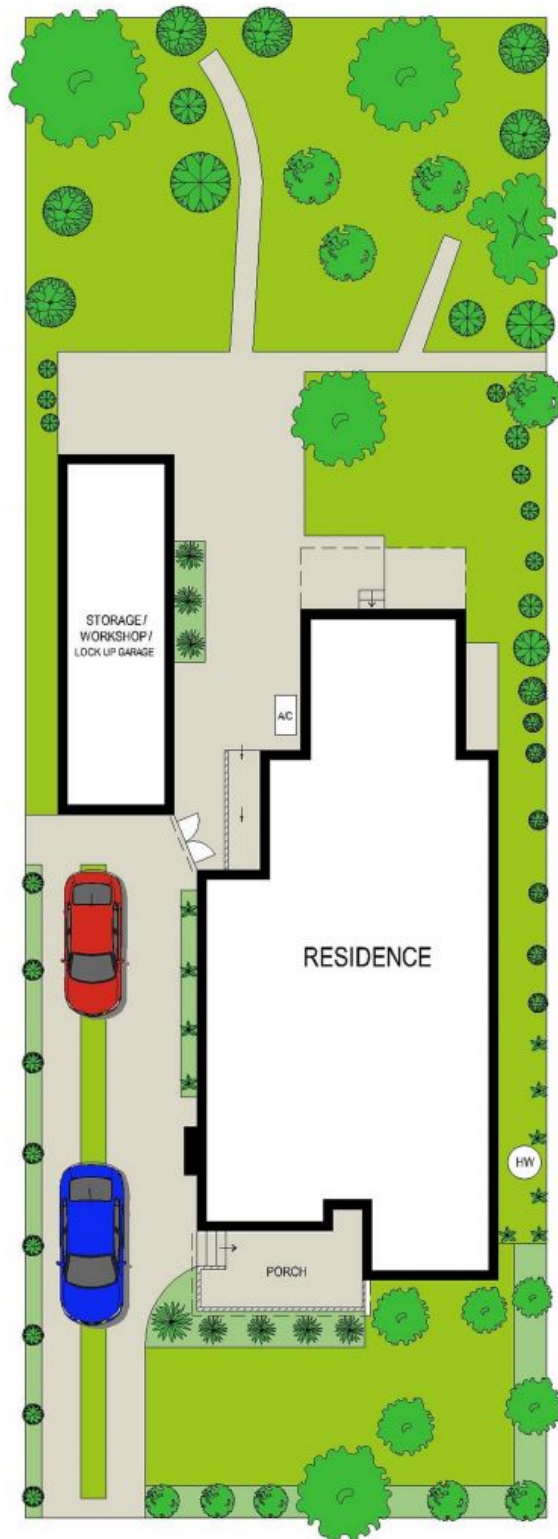

ADDRESS: **SITE PLAN (NOT TO SCALE)**  
**259 Sylvania Road South, GYMEA BAY**

DISCLAIMER: THIS IS FOR ILLUSTRATIVE PURPOSES ONLY, ALL DIMENSIONS ARE APPROXIMATE AND IT DOES NOT CONSTITUTE PART OF ANY LEGAL DOCUMENTS.

