



15 Milford Road Miranda, NSW

 5

 2

 2

## Generous Proportions

- Multiple open plan living areas with designated dining space
- Spacious kitchen equipped with European appliances and gas cooking
- Large undercover entertainer's deck overlooking a grassed yard
- Four bedrooms with built-ins, main with walk-in and ensuite
- Timber floors, high ceilings, ducted air conditioning
- Separate study, large internal laundry, recently updated throughout
- Lock-up garage, carport plus off-street parking for multiple cars
- Short walk to local schools, shops and transport options

**Price:** Contact Agent

**Council Rates:** \$527.90 p/q

**Water Rates:** \$221.55 p/q

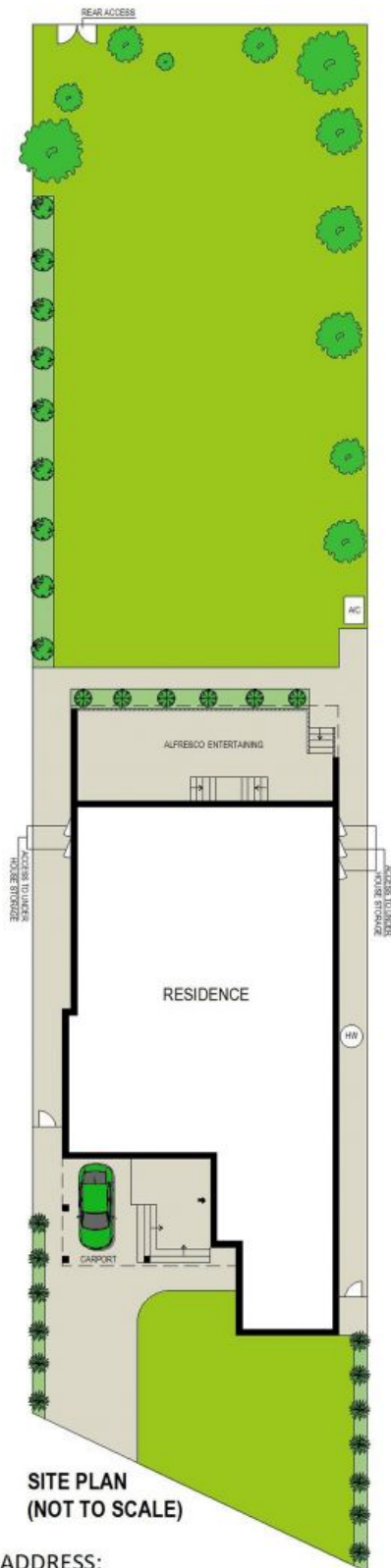

ADDRESS:  
**15 Milford Road, MIRANDA**

DISCLAIMER: THIS IS FOR ILLUSTRATIVE PURPOSES ONLY, ALL DIMENSIONS ARE APPROXIMATE AND IT DOES NOT CONSTITUTE PART OF ANY LEGAL DOCUMENTS.

