



16/113 Karimbla Road Miranda, NSW



Prime Location

- Light-filled living room with sliding doors opening onto a bright balcony
- Spacious layout with a fresh neutral colour palette throughout
- Formal dining room/living space or an easy third bedroom conversion option
- Immaculate kitchen with ample bench and storage space and breakfast bar
- Well-proportioned bathroom with both bath and shower and separate w/c
- Sunny bedrooms with generous proportions and built-in wardrobes
- Low-maintenance timber-look flooring, security intercom and internal laundry
- Well-maintained complex within close proximity to Centenary Park playground
- Great investment opportunity or comfortable home in a very lucrative suburb

Price: \$610000

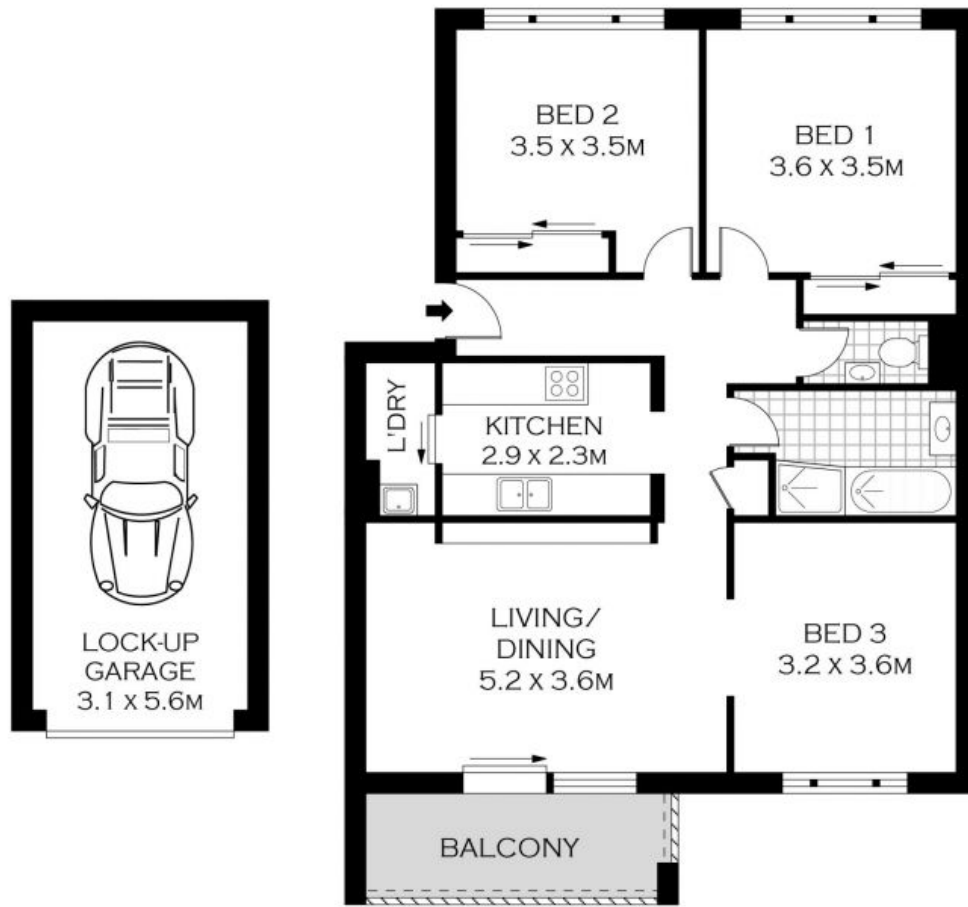

FIRST FLOOR

INT : 84.71M² 



PLANS SHOWN ONLY INDICATIVE OF LAYOUT. DIMENSIONS ARE APPROXIMATE.
Floor plans by www.remaustralia.com
Ref. No. 12817

16/113-125 KARIMBLA ROAD

MIRANDA