



6 Tyler Place Bonnet Bay, NSW



4



2



2

Tranquil Residence

- Charming north-facing facade with landscaped gardens and elevated veranda
- Spacious upstairs living with balcony access and separate dining room
- Superb balcony, perfect for enjoying the stunning outlook
- Well-proportioned kitchen with ample bench/storage space and breakfast bar
- Master bedroom with oversized windows and built-in wardrobe
- Stylish, modern main bathroom plus a convenient separate w/c
- Light filled layout with high ceilings, air conditioning and under-house storage throughout
- Versatile downstairs retreat includes fourth bedroom, laundry, bathroom and private entry.
- Covered alfresco area, landscaped gardens, level lawns and inground pool

Price: \$1100000



DISCLAIMER: THIS IS FOR ILLUSTRATIVE PURPOSES ONLY. ALL DIMENSIONS ARE APPROXIMATE AND IT DOES NOT CONSTITUTE PART OF ANY LEGAL DOCUMENTS.

6 TYLER PLACE

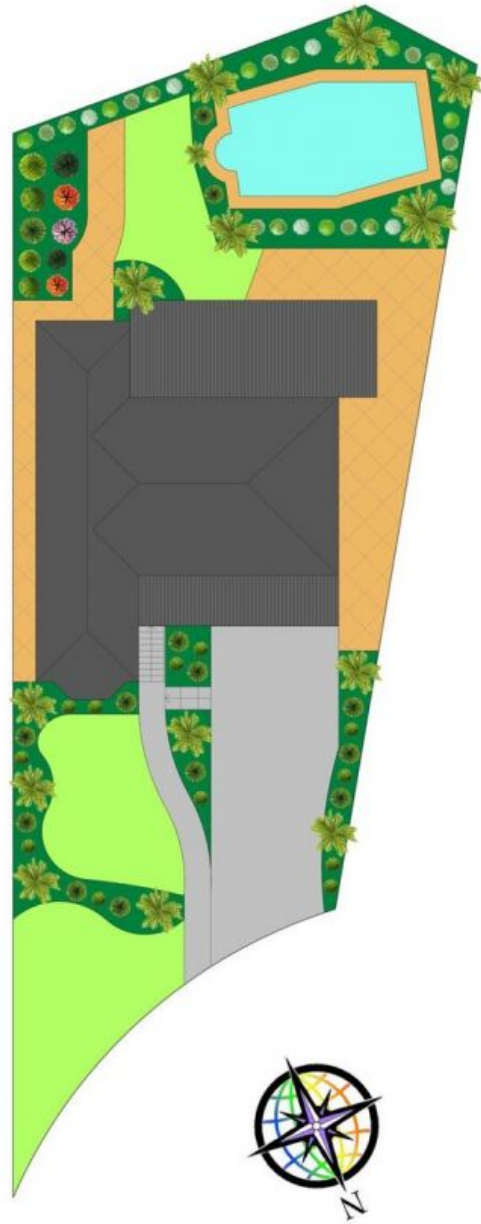

Harwood
PROPERTY AGENTS

BONNET BAY